

SEZ. A-A
SCALA 1:4

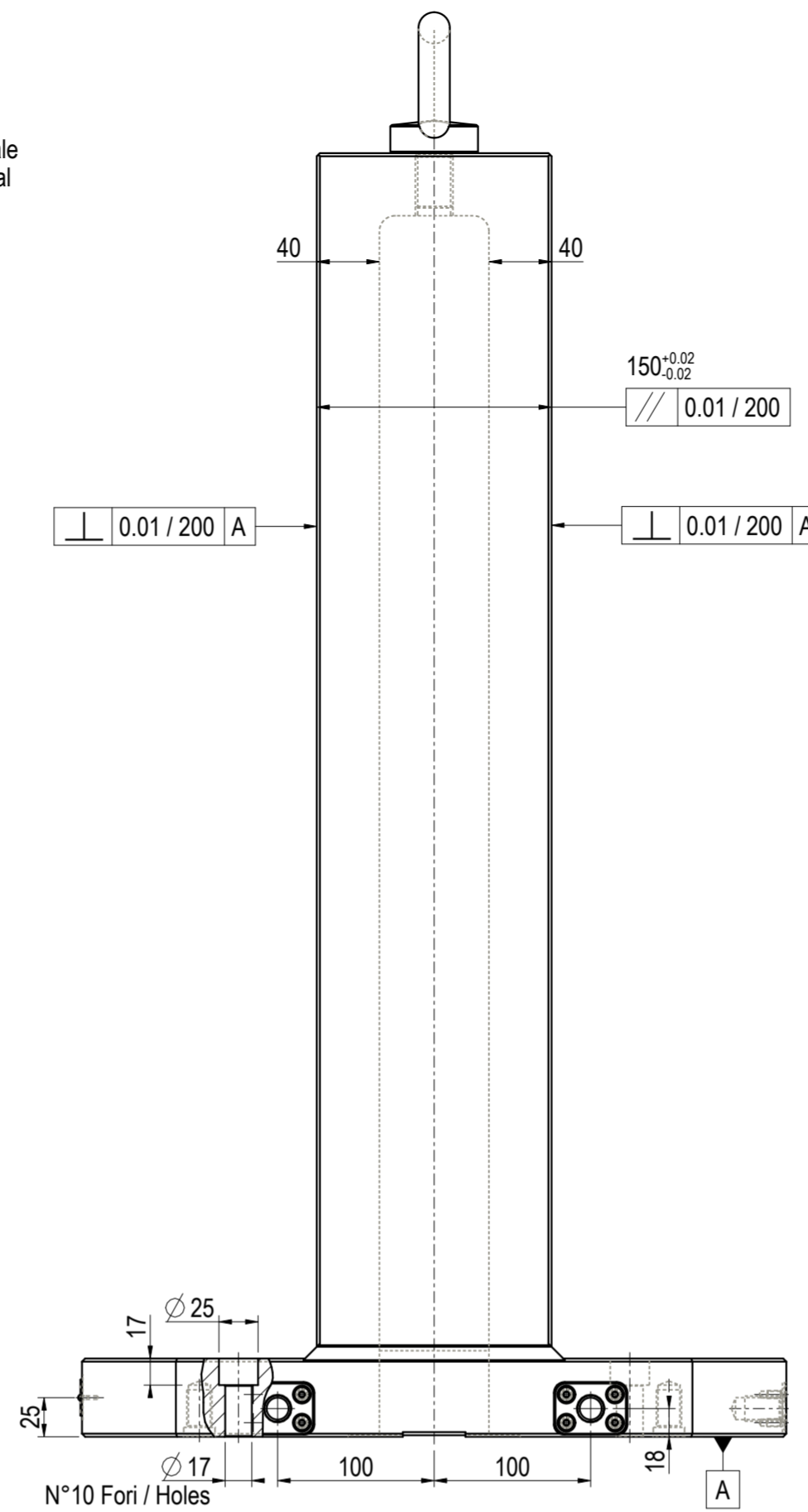

SEZ. B-B

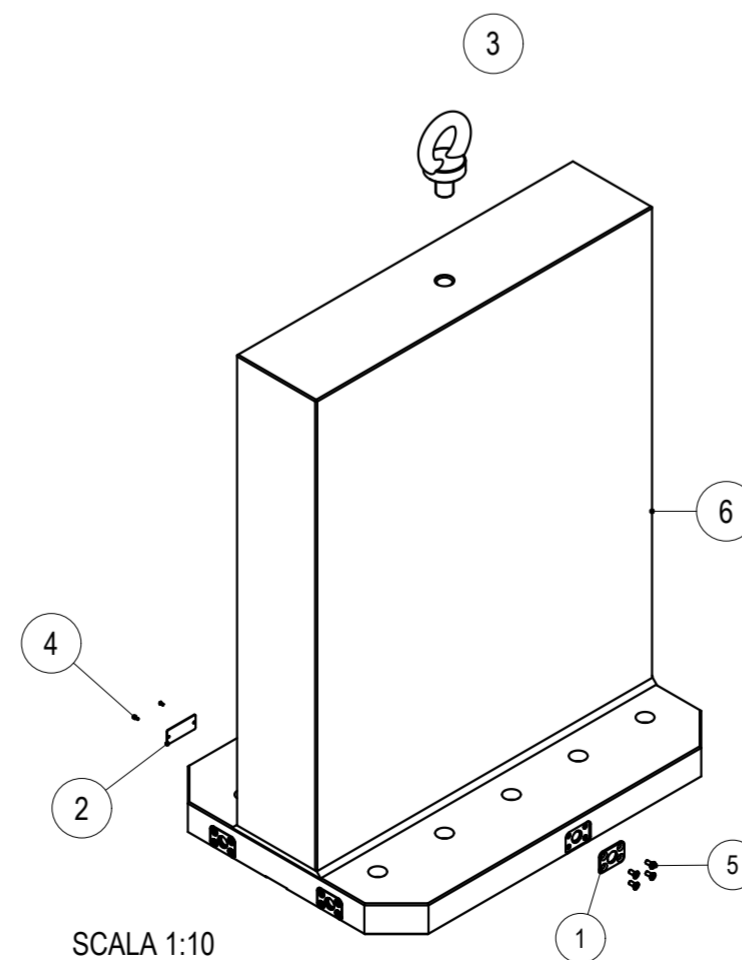
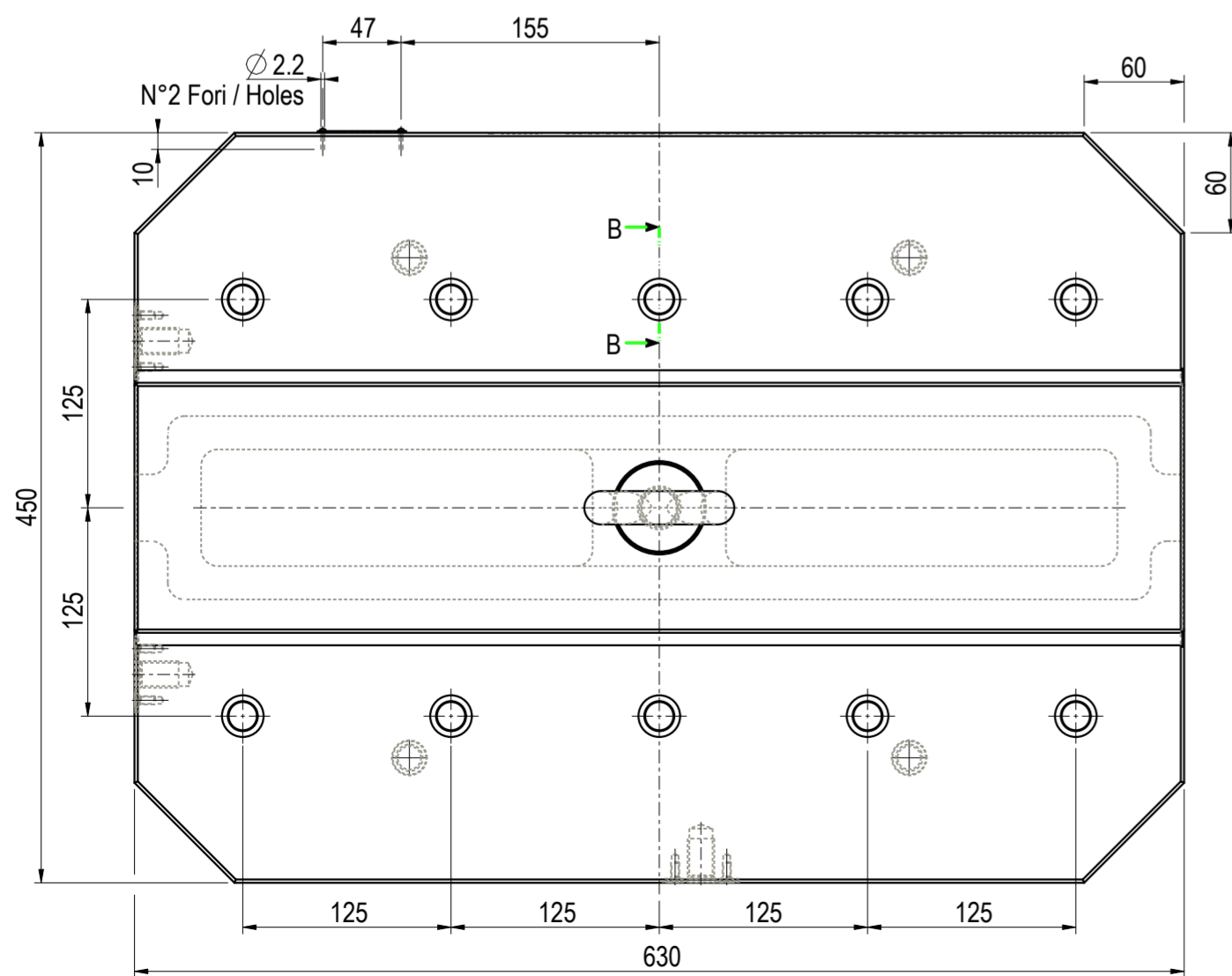
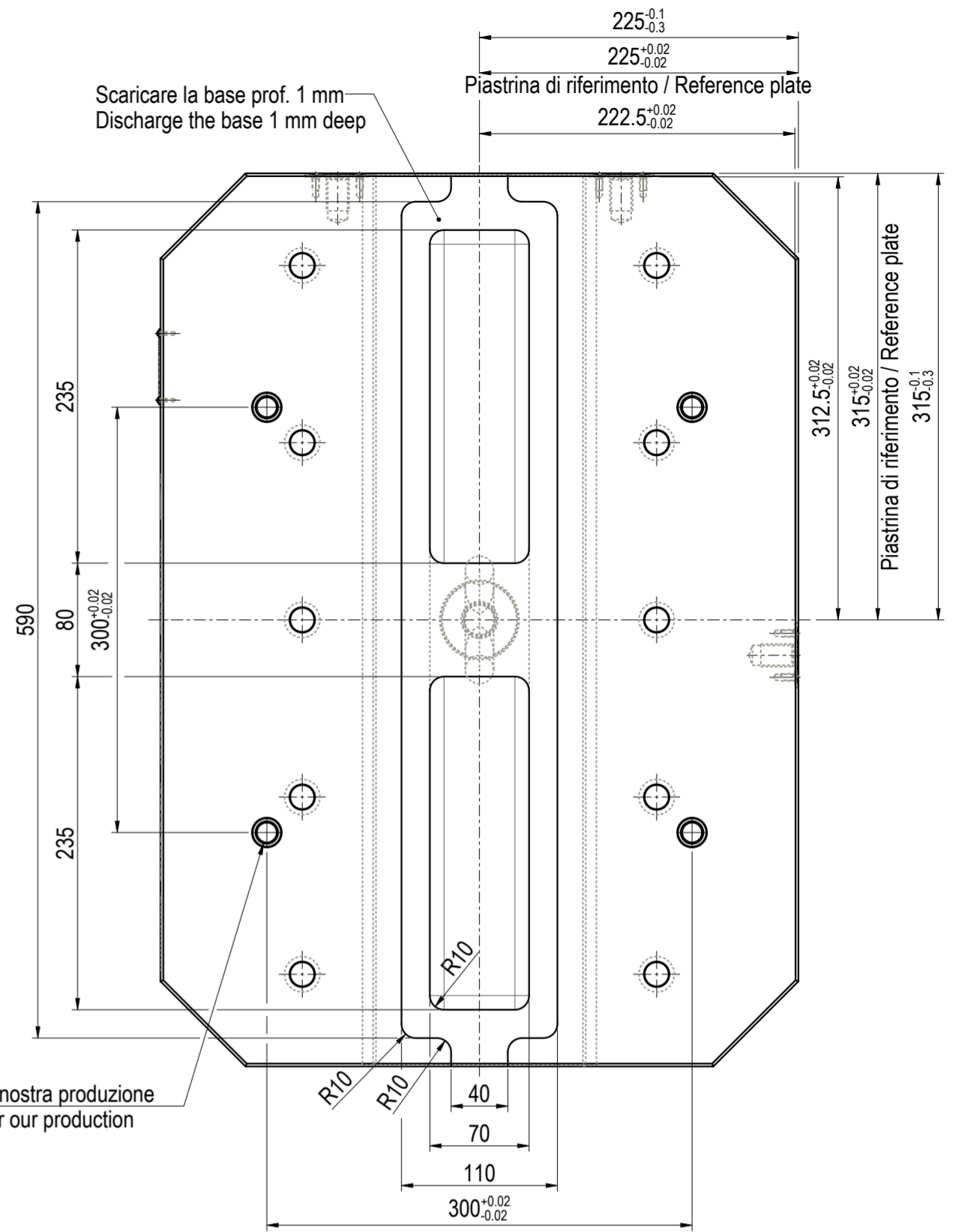

SCALA 1:10

POS.	CODICE - CODE	DESCRIZIONE - DESCRIPTION	Q.TY
1	4SH45322	Piastrina riferimento laterale Lateral reference plate	3
2	4SH53231	Piastra identificativa Portapezzi Tombstone Serial Number plate	1
3	GOLFARE_M24	Golfare M24 Eyebolt M24	1
4	RIVETTO_2-3X5	Rivetto Ø2.3 x 5 Rivet Ø2.3 x 5	2
5	VTPSEI_M5X12	Vite testa piana svasata esagono incassato Countersunk socket head screw	12
6	W0000522631	Corpo spalla completamente lavorata Art.53C / 170 Tombstone body completely machined Art.53C / 170	1

ATTENZIONE:
 - quote indicative da verificare in caso di offerta;
 - possibile presenza di lavorazioni aggiuntive e/o forature extra;
 - verificare la compatibilità della base col proprio pallet;
 - possibilità di richiedere un preventivo per eventuali modifiche o personalizzazioni.

ATTENTION:
 - indicative dimensions to be verified in the event of an offer;
 - possible presence of additional machining and/or extra drilling;
 - check the compatibility of the base with your pallet;
 - possibility to request a quote for any change or customization.

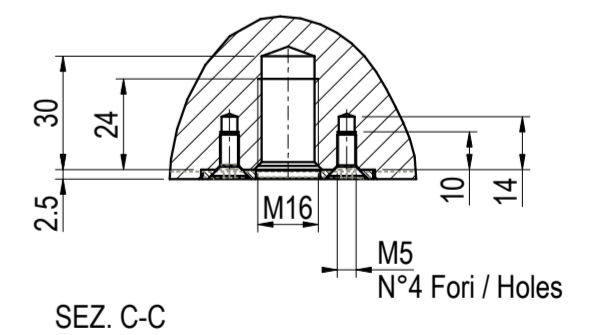
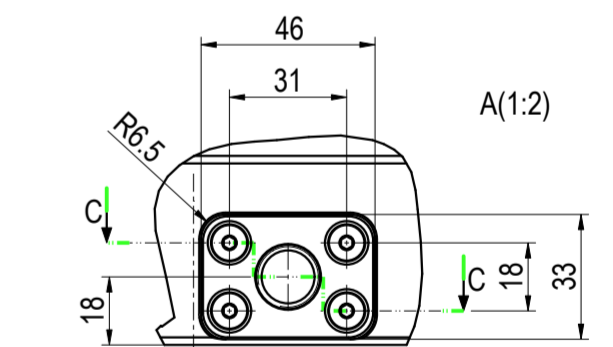

Rev.	Description	Drawn by	Date	Approved by
A		A.Vigliotta		

GERARDI S.p.A. Lonate Pozzolo (VA) Italy Tel. +39 0331303911 Fax +39 0331301534		Denominazione Denomination			Progettazione - UTILIZZO ESCLUSIVO UFFICIO TECNICO	
Articolo Article	55C	Spalla completamente lavorata Art.55C / 170 Tombstone completely machined Art.53C / 170			Cliente Customer	-
Tipo Type	170	Disegnato da Drawn by	M. Magistrelli	Approvato da Approved by	Fabbisogno Q.ty needed	0
Peso Weight	Kg. 415.0	Foglio Sheet	1 of 1	Codice commerciale Sales item code	855C00170	
Revisione Revision	A.1	Data Date	21-04-22	Disegno N° Drawing N°	W0000522629	